

**Material Specification**

Model No.	Rail	Roller	Retainer
GRV	SUJ2		SUS304
GRV-S	SUS440C+Ni	SUS440C	

**Note:** GRV\_S No Ni finish to V groove surface of rail

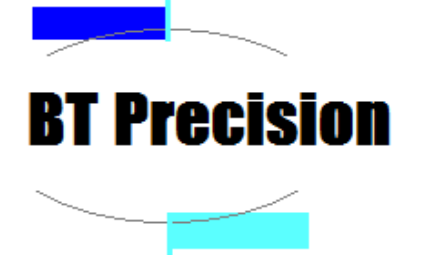

Model	Model	Max Stroke mm	Main Dimensions							Retainer Dimensions				Mounting Dimensions					Load / Roller			Weight(g)/2 pieces		
			H	T	W	L	N*P	L1	L2	ØD	L3	R	P1	P2	A	M	d1	d2	B	Dyn Load	Static Load	Allowable Load	Standard	Antirust
GRV01-20	GRV01-20-S	13	8.5	4	3.9	20	1*10	5	0.7	Ø1.5	15.8	5	1.9	3	1.8	M2	1.65	3	1.4	125N/Roller	144N/Roller	48N/Roller	4	4
GRV01-30	GRV01-30-S	21				30	2*10				21.8	7											6	7
GRV01-40	GRV01-40-S	29				40	3*10				27.8	9											8	9
GRV01-50	GRV01-50-S	37				50	4*10				33.8	11											10	11
GRV01-60	GRV01-60-S	45				60	5*10				39.8	13											12	13
GRV01-70	GRV01-70-S	53				70	6*10				45.8	15											14	16
GRV01-80	GRV01-80-S	61				80	7*10				51.8	17											16	17
GRV02-30	GRV02-30-S	24	12	6	5.5	30	1*15	7.5	1.5	Ø2	21.6	5	2.8	4	2.5	M3	2.55	4.4	2	293N/Roller	292N/Roller	97N/Roller	13	14
GRV02-45	GRV02-45-S	30				45	2*15				33.6	8											20	21
GRV02-60	GRV02-60-S	44				60	3*15				41.6	10											26	28
GRV02-75	GRV02-75-S	58				75	4*15				49.6	12											32	35
GRV02-90	GRV02-90-S	72				90	5*15				57.6	14											39	42
GRV02-105	GRV02-105-S	86				105	6*15				65.6	16											45	48
GRV02-120	GRV02-120-S	100				120	7*15				73.6	18											51	55
GRV02-135	GRV02-135-S	106				135	8*15				85.6	21											58	62
GRV02-150	GRV02-150-S	120				150	9*15				93.6	23											64	69
GRV02-165	GRV02-165-S	134				165	10*15				101.6	25											70	76
GRV02-180	GRV02-180-S	148	180	11*15	109.6	27	77	82																
GRV03-50	GRV03-50-S	34	18	8	8.3	50	1*25	12.5	2	Ø3	36.4	7	3.2	5	3.5	M4	3.3	6	3.1	638N/Roller	761N/Roller	254N/Roller	46	49
GRV03-75	GRV03-75-S	54				75	2*25				51.4	10											68	73
GRV03-100	GRV03-100-S	74				100	3*25				66.4	13											90	97
GRV03-125	GRV03-125-S	104				125	4*25				76.4	15											112	120
GRV03-150	GRV03-150-S	124				150	5*25				91.4	18											134	144
GRV03-175	GRV03-175-S	144				175	6*25				106.4	21											157	168
GRV03-200	GRV03-200-S	164				200	7*25				121.4	24											179	191
GRV03-225	GRV03-225-S	184				225	8*25				136.4	27											201	215
GRV03-250	GRV03-250-S	204				250	9*25				151.4	30											223	239
GRV03-275	GRV03-275-S	224				275	10*25				166.4	33											245	262
GRV03-300	GRV03-300-S	244	300	11*25	181.4	36	267	286																

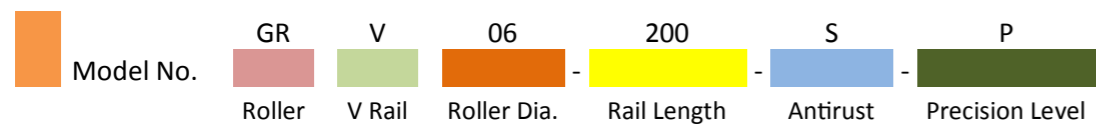



**Material Specification**

Model No.	Rail	Roller	Retainer
GRV	SUJ2		SUS304
GRV-S	SUS440C+Ni	SUS440C	

**Note:** GRV\_S No Ni finish to V groove surface of rail

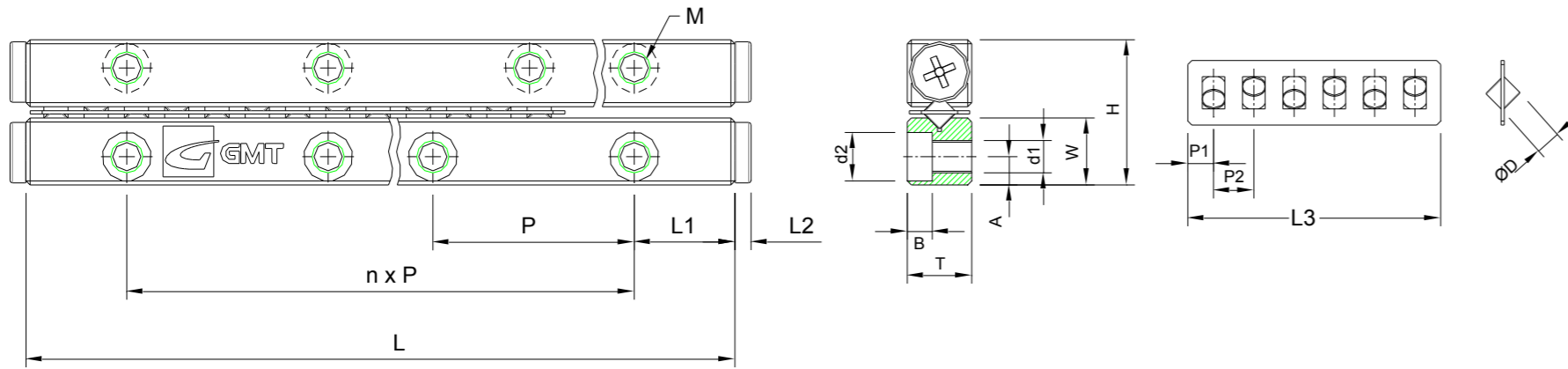
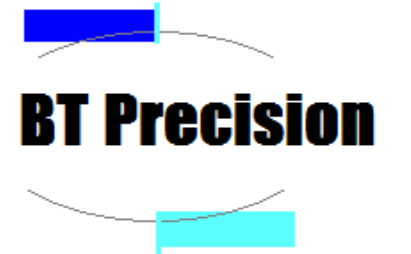

Model	Model	Max Stroke mm	Main Dimensions						Retainer Dimensions				Mounting Dimensions				Load / Roller			Weight(g)/2 pieces				
			H	T	W	L	N*P	L1	L2	ØD	L3	R	P1	P2	A	M	d1	d2	B	Dyn Load	Static Load	Allowable Load	Standard	Antirust
GRV04-80	GRV04-80-S	54	22	11	10	80	1*40	20	2	Ø4	57.6	8	4.3	7	4.5	M5	4.3	7.5	4.1	1230N/Roller	1170N/Roller	390N/Roller	122	130
GRV04-120	GRV04-120-S	92				120	2*40				78.6	11											180	193
GRV04-160	GRV04-160-S	130				160	3*40				99.6	14											238	254
GRV04-200	GRV04-200-S	154				200	4*40				127.6	18											296	317
GRV04-240	GRV04-240-S	192				240	5*40				148.6	21											355	380
GRV04-280	GRV04-280-S	230				280	6*40				169.6	24											413	442
GRV04-320	GRV04-320-S	254				320	7*40				197.6	28											472	505
GRV04-360	GRV04-360-S	292				360	8*40				218.6	31											530	568
GRV04-400	GRV04-400-S	330				400	9*40				239.6	34											589	631
GRV04-440	GRV04-440-S	354				440	10*40				267.6	38											647	694
GRV04-480	GRV04-480-S	392				480	11*40				288.6	41											706	756
GRV06-100	GRV06-100-S	80	31	15	14	100	1*50	25	2	Ø6	64.8	7	5.4	9	6	M6	5.3	9.5	5.2	2570N/Roller	2632N/Roller	877N/Roller	287	311
GRV06-150	GRV06-150-S	108				150	2*50				100.8	11											435	466
GRV06-200	GRV06-200-S	154				200	3*50				127.8	14											577	618
GRV06-250	GRV06-250-S	200				250	4*50				154.8	17											721	773
GRV06-300	GRV06-300-S	246				300	5*50				181.8	20											864	925
GRV06-350	GRV06-350-S	274				350	6*50				217.8	24											1006	1078
GRV06-400	GRV06-400-S	320				400	7*50				244.8	27											1150	1232
GRV06-450	GRV06-450-S	366				450	8*50				271.8	30											1292	1385
GRV06-500	GRV06-500-S	412				500	9*50				298.8	33											1436	1539
GRV06-550	GRV06-550-S	458				550	10*50				325.8	36											1579	1691
GRV06-600	GRV06-600-S	486				600	11*50				361.8	40											1273	1846

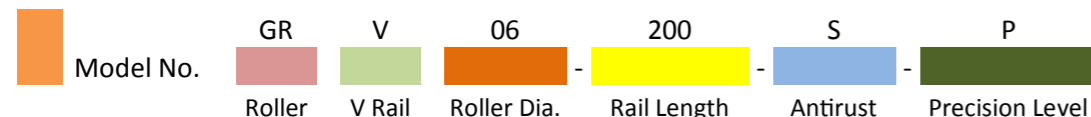

[www.gmtlinear.com](http://www.gmtlinear.com)

[www.btprecision.com.au](http://www.btprecision.com.au)



**Material Specification**

Model No.	Rail	Roller	Retainer
GRV	SUJ2		SUS304
GRV-S	SUS440C+Ni	SUS440C	

**Note:** GRV\_S No Ni finish to V groove surface of rail

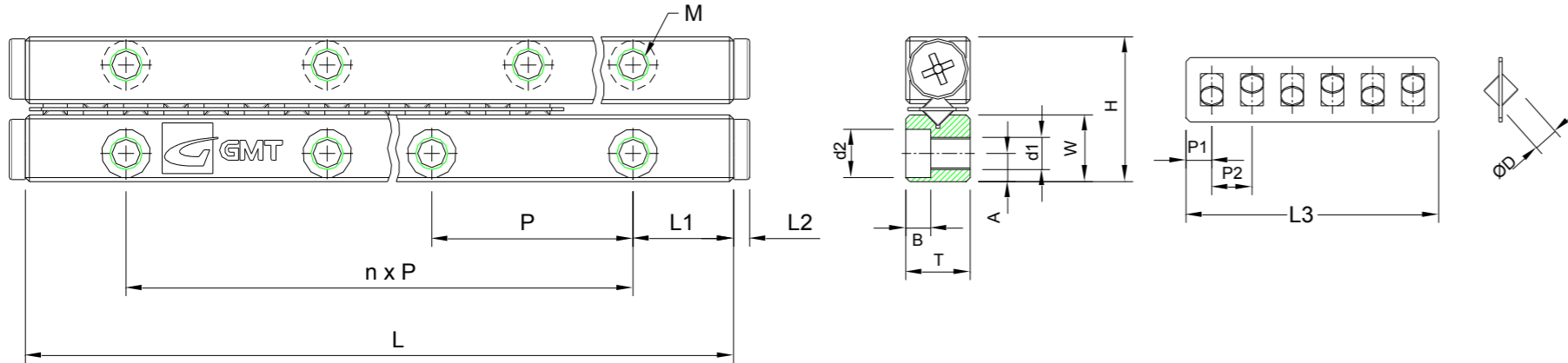
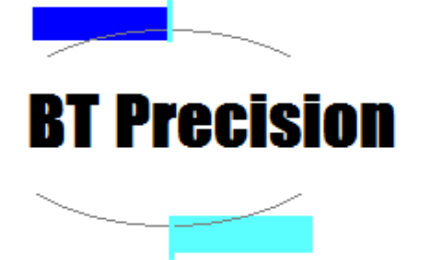

Model	Model	Max Stroke mm	Main Dimensions							Retainer Dimensions				Mounting Dimensions					Load / Roller			Weight(g)/2 pieces		
			H	T	W	L	N*P	L1	L2	ØD	L3	R	P1	P2	A	M	d1	d2	B	Dyn Load	Static Load	Allowable Load	Standard	Antirust
GRV09-200		158	44	22	20.2	200	1*100	50	3.5	Ø9	130	9	9	14	9	M8	6.8	10.5	6.2	7190N/Roller	7274N/Roller	2425N/Roller	1267	
GRV09-200		246				300	2*100				186	13											1891	
GRV09-200		306				400	3*100				256	18											2509	
GRV09-200		394				500	4*100				312	22											3133	
GRV09-200		482				600	5*100				368	26											3756	
GRV09-200		570				700	6*100				424	30											4628.1	
GRV09-200		658				800	7*100				480	34											4915.2	
GRV09-200		746				900	8*100				536	38											5525.3	
GRV09-200		806				1000	9*100				606	43											6140.9	
GRV09-200		894				1100	10*100				662	47											6751.1	
GRV09-200		982				1200	11*100				718	51											7361.2	
GRV12-200		160				58	28				26.9	200											1*100	50
GRV12-300		216	300	2*100	202			11	3161															
GRV12-400		308	400	3*100	256			14	4195															
GRV12-500		400	500	4*100	310			17	5242															
GRV12-600		492	600	5*100	364			20	6276															
GRV12-700		548	700	6*100	436			24	7734.8															
GRV12-800		640	800	7*100	490			27	8829.2															
GRV12-900		732	900	8*100	544			30	9261.2															
GRV12-1000		824	1000	9*100	598			33	10281.7															
GRV12-1100		916	1100	10*100	652			36	11302.3															
GRV12-1200		972	1200	11*100	724			40	12336.4															

